

## DATA SHEET: TEMBREAK 2 E250-SCF MCCB

MCCB Electrical Characteristics to IEC 60947-2, EN 60947-2, JIS C 8201-2-1 ANN.1, NEMA AB-1

Frame Reference	Quantity	Unit	Condition	TB2 Lite 250
Max In (A) of Frame				250
Model				E250
Number of Poles				3, 4
Type				SCF
<b>Nominal current ratings</b>				
	In	(A)	50°C	125,150,175 200,225, 250
<b>Electrical characteristics</b>				
Rated operational voltage	U <sub>e</sub>	(V)	AC 50/60 Hz DC	525 250
Rated insulation voltage	U <sub>i</sub>	(V)		690
Rated impulse voltage	U <sub>imp</sub>	(kV)		8
Ultimate breaking capacity (IEC, JIS, AS/NZS)	I <sub>cu</sub>	(kA)	690V AC	-
			525V AC	6
			440V AC	10
			400/415V AC	16
			220/240V AC	25
250V DC	13			
Service breaking capacity (IEC, JIS, AS/NZS)	I <sub>cs</sub>	(kA)	690V AC	-
			525V AC	3
			440V AC	5
			400/415V AC	8
			220/240V AC	13
250V DC	7			
Rated breaking capacity (NEMA)		(kA)	480V AC	6
			240VAC	25
<b>Protection</b>				
Fixed thermal, fixed magnetic				■
Adjustable thermal, adjustable magnetic				-
Utilisation category				A
<b>Installation</b>				
Front connection (FC)				■
Extension bar (FB)				•
Cable clamp (FW)				•
Rear connection (RC)				•
Plug-in (PM)				-
DIN rail mounting (DA)				-
Dimensions	height	(mm)		165
	width	(mm)	3 pole 4 pole	105 140
Weight	depth	(mm)		68
	weight	(kg)	3 pole 4 pole	1.5 1.9
<b>Operation</b>				
Direct Opening Action				■
Toggle operation				■
Door mounted (HS) / Breaker mounted handle (HB)				•
Motor operation				•
Endurance	Electrical Mechanical	cycles cycles	415V AC	6,000 18,000

■ Standard    • Optional    - Not Available

## DATA SHEET: TEMBREAK 2 E250-SCF MCCB

### Outline Dimensions E250-SCF

ASL: Arrangement Standard Line H: Handle Frame Centre Line C: Handle Centre Line

#### Front connected

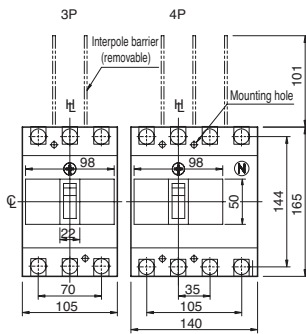

#### Preparation of conductor

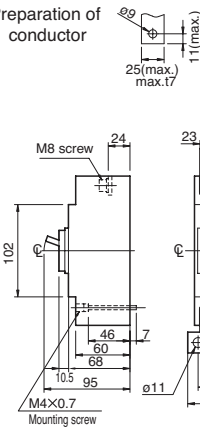

#### With extension bars (optional)

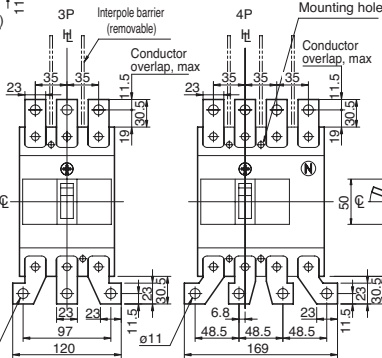

#### Drilling plan (front view)

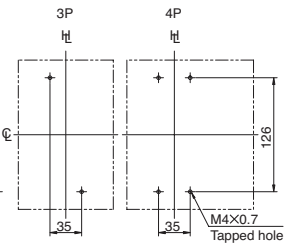

Note: For the extension bars, Straight bars or Spread bars can be supplied.

#### Rear connected

#### Detail of connecting part

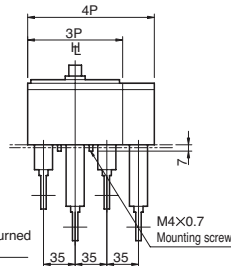
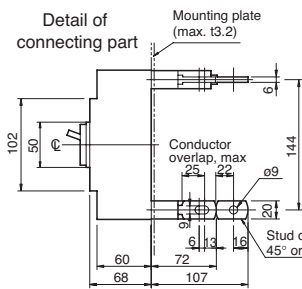

#### Drilling plan (front view)

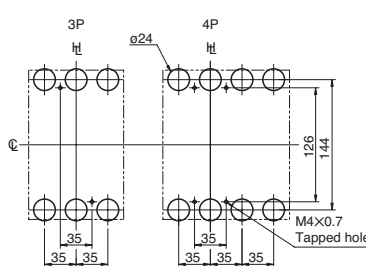

#### Panel cutout (front view)

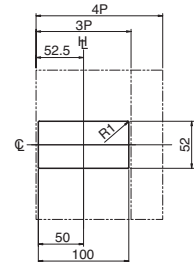

Panel cutout dimensions shown give an allowance of 1.0mm around the handle escutcheon.

## DATA SHEET: TEMBREAK 2 E250-SCF MCCB

### Time/Current Characteristic Curves E250-SCF

